

Making a Constrained Lot Usable

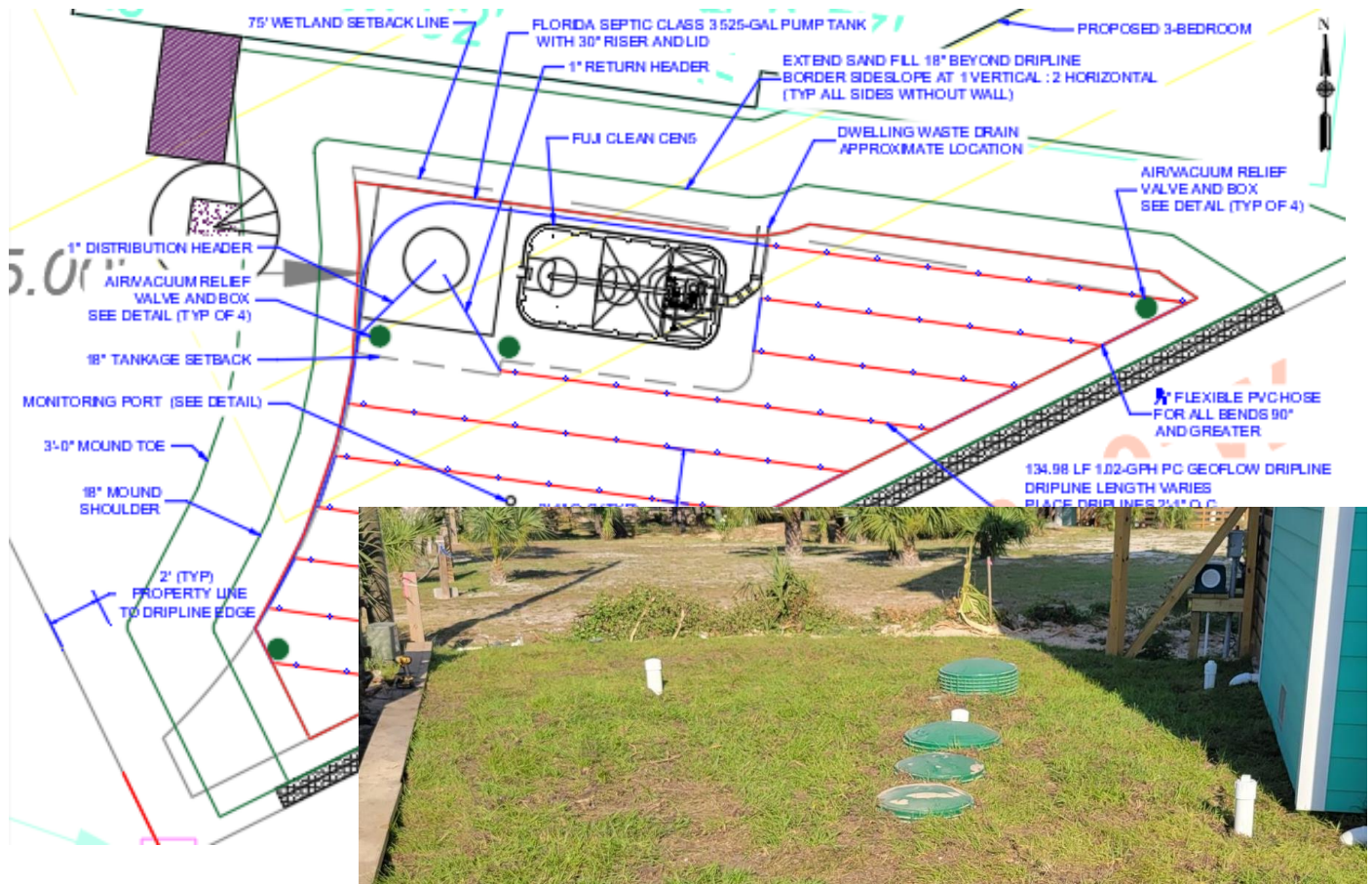

Problem:

How to provide onsite treatment and disposal for a proposed three-bedroom dwelling when there is a protected wetland that takes up much of the lot and has a 75-foot setback?

- Site: Three-bedroom house on St. George Island
- Total lot size: 1 acre
- Total Available Tank and Drainfield Area: 392 ft²
- Distance to: Neighbor's Irrigation Well 25-ft.
- Inches to Seasonal Saturation: 16"
- What's left? Triangular area at corner of lot.

Solution:

FujiClean Model CEN5 (Design capacity; 500-gpd)

- High quality treatment and dripline dispersal for nitrogen removal and drainfield reduction.
- One tank treatment, 540-gallon pump tank, and dripline irrigation field providing 225 ft² minimum dispersal area.
- At grade access ports do not detract from unique dwelling.
- Whisper quiet blower (<40 dB) in sync with serene surroundings.
- Lightweight tank (705 lbs.) easy to maneuver into location.
- One simple 3/4" airline hookup minimizes excavation requirements.

Engineer, Bennette D. Burks, P.E., 3-Engineering, LLC, Richmond, VA

Adapted from Onsite Installer Magazine, April 2024